

MANUAL OF INSTALLATION

NAVIBACK RENAULT

RENAULT LAGUNA 3 / MEGANE 3 plug & play KIT
For the connection between steering wheel commands
With TOM TOM system and aftermarket radio rev 1.0 12

DESCRIPTION

NAVIBACK is a kit expressly created for the RENAULT LAGUNA & MEGANE 3 vehicles, it allows to substitute the OEM radio recovering the steering wheel commands functions and the TOM TOM navigation OEM kit's ones.

The kit is composed by two modules: the first is UNICAN PLUS (with 6 radio adapters) compatible with the following brands: CLARION, KENWOOD, JVC, ALPINE, PIONEER, SONY, PANASONIC and BLAUPUNKT. UNICAN PLUS allows you to recover the steering wheel commands.

The other module is NAVIMUSIC (with plug&play cable) that allows the TOMTOM navigation kit restoring. Bluetooth function is not restorable because the unit is included in the OEM radio.

INSTALLATION

The kit is completely PLUG&PLAY.

Anyway we advise you to follow the instructions of connection described here below:

Removed the OEM radio from its place, the installer has to identify the FAKRA connector belonging to the original audio system; the connector in object is the one before connected to the OEM radio.

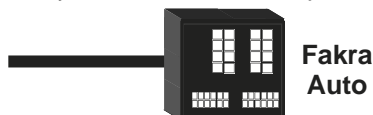

Now, connect the steering wheel commands adapter inserting the car connector to the UNICAN PLUS connector.

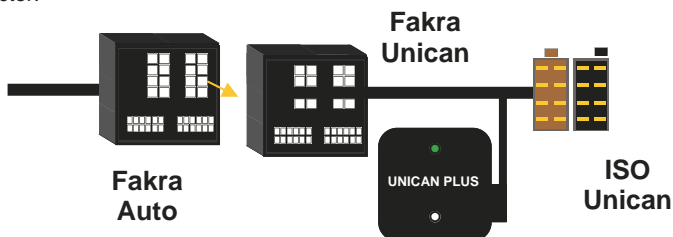

GUARANTY

THIS PRODUCT HAS A TWO-YEAR GUARANTY FOR ANY KIND OF PRODUCTION DEFECT. THE FISCAL SALES DOCUMENT IS NECESSARY FOR THE VALIDITY OF THE GUARANTY

Now, connect to the steering wheel commands adapter the module Navimusic inserting the ISO connectors to the UNICAN PLUS ones.

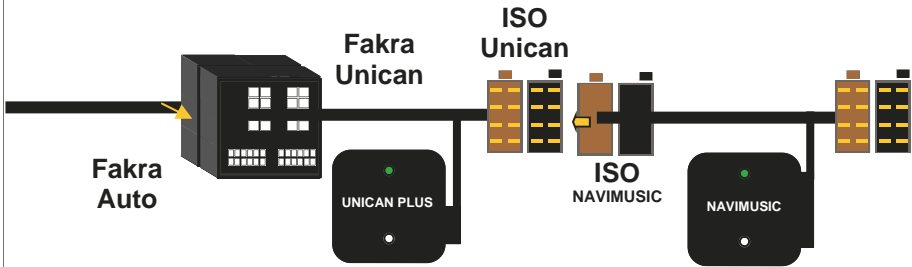

Connect the Navimusic ISO connector to the aftermarket radio ISO connector.
Connect the UNICAN PLUS plug adapter (for the radio functions control) to the dedicate input located back the aftermarket radio. Connect the YELLOW WHITE wire as below described.

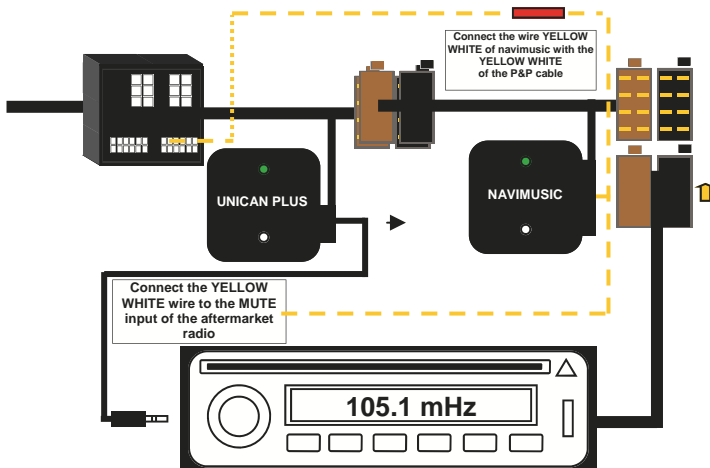

SELF-RECOGNIZING AND FUNCTIONS

Once you did the connections, it's necessary to select the model of radio you want to combine with UNICAN PLUS. The led of the module must flash GREEN (if it's fixed, please press the RESET button till the led switches off, and then release it).
The selection of the CANBUS protocol is in **SELF-RECOGNIZING** mode.



As soon as the synchronization is done, it will be selected the car protocol: this operation is confirmed by the led of the module that will flash GREEN.

Now, the unit is ready to SELECT THE RADIO.



By default, the module presents the first selectable radio, that's the CLARION one; the GREEN led will flash 1 time. The table here attached describes the position of the radios.
To select a different radio, please press VOLUME + (to go on in the list) or VOLUME - (to go back in the list). Once you have selected the radio, please confirm the choice by pressing SEEK + button. The GREEN led will become fixed to confirm it.
About the ALPINE, PIONEER and SONY radios, it's also necessary to set the JUMPER JP1 correctly (see the table here below).

JUMPERS

1 2 3
○ ○ ○ J1
○ ○ ○ J2
○ ○ ○ J3
○ ○ ○ J4
○ ○ ○ J5



	1 - 2	2 - 3
J1	ALPINE - SONY OUTPUT	PIONEER OUTPUT
J2	GND BRAKE OUTPUT	POSITIVE BRAKE OUTPUT
J3	GND BACK OUTPUT	POSITIVE BACK OUTPUT
J4	BLAUPUNKT OUTPUT	
J5	K-BUS MANAGING	CAN-BUS MANAGING

CBL007UNAL22	ALPINE ADAPTER
CBL007UNBL12	BLAUPUNKT ADAPTER
CBL007UNCL12	CLARION / JVC ADAPTER
CBL007UNKE11	KENWOOD ADAPTER
CBL007UNPI12	PIONEER SONY ADAPTER
CBL007UNPN21	PANASONIC ADAPTER

NAVIMUSIC technical details

The power feeding is +12V with GND at ground.

The audio volume is settable by external trimmers available on the interface.

The power of the Navimusic's final transistor supplies 22 Watt.

POWER FEEDING	+12 VDC
WORKMODE CONSUMPTION	5A
SLEEPING MODE CONSUMPTION	<3mA
PLASTIC BOX SIZE	6.70x6.70x2.8 cm
WEIGHT FOR UNIT	45 g

TECHNICAL FEATURES OF UNICAN

POWER FEEDING	10/16 VDC
SLEEPING CONSUMPTION	0,001 A
WORKMODE CONSUMPTION	0,040 A
CHARGE MAX POSITIVE IGNITION OUTPUT	0,500 A
CHARGE MAX LIGHTS OUTPUT	0,040 A

NAVIMUSIC AUDIO REGULATION

The unit is set at an ideal level of AUDIO volume. However it's possible to regulate by using the trimmers available on the circuit, to lower the volume please rotate clockwise.

ATTENTION! DO NOT REGULATE THE TRIMMERS BEFORE CONTACTING THE TECHNICAL ASSISTANCE SERVICE!

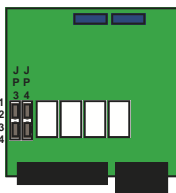
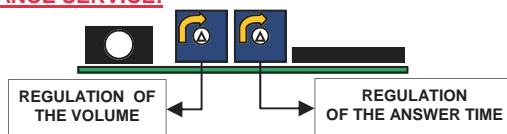

If the vehicle is equipped with an OEM amplifier (booster) please set the jumpers as described in the picture beside. We suggest that if it's possible to connect the unit to an external speaker.

Also with the external speaker follow the jumper setting of the picture.

ANOMALIES

- The unit does not work and the LED is off.
- Verify the connection to the power feeding.
- The unit, correctly powered, does not work and the LED is off.
- Verify the CANBUS connections.
- The unit is correctly connected and the LED flashes RED quickly.
- The unit cannot synchronize itself with CANBUS; please contact Paser.
- The unit is correctly connected and the LED flashes RED regularly.
- Verify the CANBUS connections.
- The unit is correctly connected and the LED is RED fixed.
- The unit has done the synchronization with CANBUS but it does not recognize the car; please contact Paser.
- The unit is correctly connected and the LED is fixed GREEN but it does not control the radio.
- Verify the JACK of the unit is connected to the radio REMOTE input.
- Increasing the volume of the radio, Navimusic turns on but it disconnects the speakers.
- Connect the aftermarket radio to an additional GND by using a big section cable.